

Blu Marine

Limassol, Limassol

€1,280,000

Ref: CY.BLU.0000

Europe's New Riviera Blu Marine is a first class freehold investment opportunity with an upside outlook. 330 meters from the Limassol Marina, in the heart of everything in Limassol's downtown and surrounded by billions worth infrastructure investments - this area will change the face and status of Cyprus and drive the economy for years to come. Inspirational Master Planned Blu Marine designed and master plan embodies the international experience of world renowned UK architects and engineers Benoy and Burro Hapold as well as Leptos Group's local expertise and experience in developing extraordinary destinations with global appeal. The design is inspired and very much celebrates Blu Marine's seafront vibrant location in the heart of everything. Uncompromised Sea Views The articulated residential towers...

Telephone: +44 1902 875395

Email: info@global-broker.co.uk

Global Resorts & Developments Deansgate 62-70 Tettenhall Road
Wolverhampton WV1 4TH



Gallery

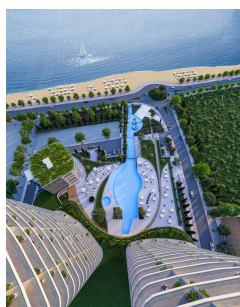
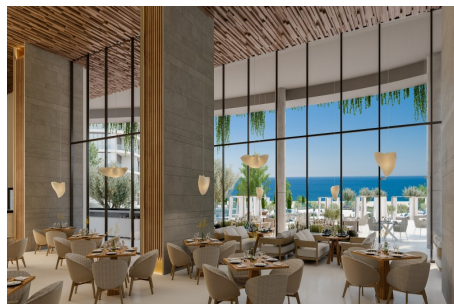
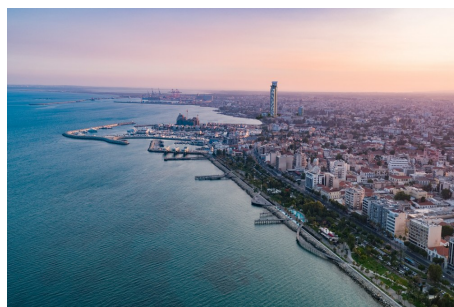

Telephone: +44 1902 875395

Email: info@global-broker.co.uk

Global Resorts & Developments Deansgate 62-70 Tettenhall Road
Wolverhampton WV1 4TH



Property Description

Location: Limassol, Limassol, cyprus

Europe's New Riviera

Blu Marine is a first class freehold investment opportunity with an upside outlook.

330 meters from the Limassol Marina, in the heart of everything in Limassol's downtown and surrounded by billions worth infrastructure investments-this area will change the face and status of Cyprus and drive the economy for-years to come.

Inspirationally Master Planned

Blu Marine designed and master plan embodies the international experience of world renown UK architects and engineers Benoy and BurroHapold as well as Leptos Group's local expertise and experience in developing extraordinary destinations with global appeal. The design is inspired and very much celebrates Blu Marines seafront vibrant location in the heart of everything.

Uncompromised Sea Views

The articulated residential towers rising above the podium allow all residences the finest city and Mediterranean views.

World Class Services & Facilities

A wealth of world class facilities spread within 13,000 sqm alongside 24hr concierge services, housekeeping, property and rental management services will cater for every need.

Telephone: +44 1902 875395

Email: info@global-broker.co.uk

Global Resorts & Developments Deansgate 62-70 Tettenhall Road
Wolverhampton WV1 4TH



Additional Info

For Sale	Beds: 2	Type: Resort Property
Breathtaking Sea Views	Water Front Living	High-end Luxury Apartments
Concierge Services	Resident's Outdoor Pool	Modern Gym
Heated Indoor Pool	Resident's Spa Centre	Bistro & Restaurant
Car Park	Children's Play Area	